

To light bars

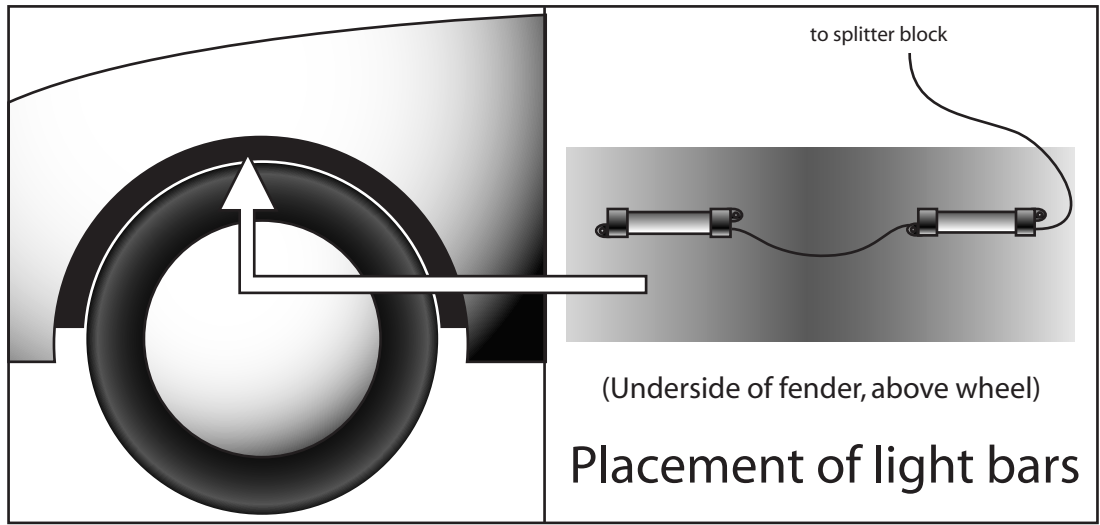
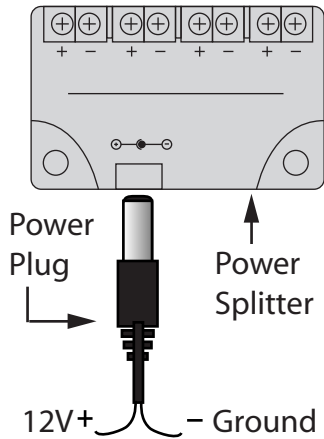

LED Wheel Well Kits

Installation Instructions

REVIEW ALL INSTRUCTIONS PRIOR TO INSTALLATION TO PREVENT INJURY OR DAMAGE

1. Determine the placement of the power splitter in a dry, secure area near your battery, where it will not be near to extreme heat or moving parts. Mount the power splitter securely using any or all of the following: Tie Wraps, Adhesive Tape, Self Tapping Screws.

2. Connect the negative (black) lead on the power plug to your frame or the ground (-) terminal on your battery. Then connect the positive (white) wire to a switch or 12V (+) source. Make sure you wrap all exposed wire with electrical tape, and secure all excess wire away from extreme heat or moving parts. Connect the power plug to the power splitter. If this plug is removed from the splitter, the entire Wheel Well Kit will be disabled.

3. Remove all light bars from packaging, and determine which one will be placed on each wheel. The light bar with the longest wire will be placed farthest from the power splitter, and the light bar with the shortest wire will be placed closest to the power splitter. Also, try to estimate whether or not the supplied wire will reach. On some oversized vehicles, you will need extra wire to complete the installation.

4. Mount the light bars as shown in the figure above. They should be placed

above the wheel, facing downward. MAKE SURE THAT THERE IS ENOUGH CLEARANCE IN YOUR WHEEL WELL! If your tire is too close to your wheel well, under extreme circumstances it may be compressed upward and crush the LED light bars. PlasmaGlow will not be responsible for such damage. Use the supplied self-tapping screws to mount the light bars. Make sure that there is nothing on the other side of the wheel well that would be damaged by drilling through it.

5. After mounting all of the light bars, all wires must be run to the power splitter near your battery. Follow these guidelines when doing so:

Wrap any extensions that you may have made with plenty of electrical tape to keep them waterproof.

Keep all wires away from any source of extreme heat or pinching/movement

Secure any extra wire safely away from dragging or sagging by using tie-wraps or other method.

6. Insert stripped wire ends into the mounted power splitter near your battery. Make sure all wires are secured, so that they cannot be pulled out of the splitter. Enjoy your kit!

LIFETIME WARRANTY

PlasmaGlow will warranty the repair/replacement of products due to defects in material and/or workmanship according to the following limitations and conditions.

- 1 Broken tube and/or glass is not covered.
- 2 Applicable Labor and Transport charges may apply.
- 3 Warranty applies only to original purchaser.
- 4 Proof of purchase is required for warranty replacement.
- 5 Normal wear, accidental damage, abuse, neglect and improper installation are not covered under the lifetime warranty.
- 6 This warranty is limited to replacing or repairing the defective part and PlasmaGlow will not be responsible for consequential damages.
- 7 For detailed warranty information, please visit:
www.plasmaglow.com

PlasmaGlow Neon
Gilbert, AZ 85233

Lighting Evolved
PLASMA GLOW
www.plasmaglow.com